

General Characteristics

Model number (on compressor nameplate)		NTZ096A4LR1A
Code number for Singlepack*		120F0003
Code number for Industrial pack**		120F0010
Drawing number		8502012g
Suction and discharge connections		Rotolock
Suction connection		1-3/4" Rotolock
Discharge connection		1-1/4" Rotolock
Suction connection with supplied sleeve		7/8" ODF
Discharge connection with supplied sleeve		3/4" ODF
Oil sight glass		Threaded
Oil equalisation connection		3/8" flare SAE
Oil drain connection		None
LP gauge port		Schrader
IPR valve		30 bar / 8 bar
Cylinders	2	
Swept volume	96 cm ³ /rev	
Displacement @ Nominal speed	16.7 m ³ /h @ 2900 rpm - 20.2 m ³ /h @ 3500 rpm	
Net weight	35 kg	
Oil charge	1.8 litre, POE - 160Z	
Maximum system test pressure Low Side / High side	25 bar(g) / 30 bar(g)	
Maximum differential test pressure	30 bar	
Maximum number of starts per hour	12	
Refrigerant charge limit	5 kg	
Approved refrigerants	R404A, R507A	

Dimensions

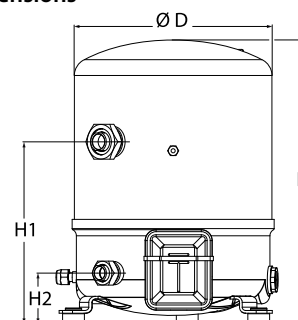

D=288 mm
H=413 mm
H1=265 mm
H2=74 mm
H3=- mm

Terminal box

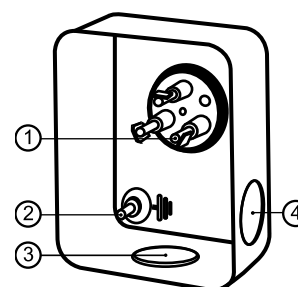

IP55 (with cable gland)

- 1: Spade connectors 1/4"
- 2: Earth M4-12
- 3: Knock-out Ø 21 mm (0.83")
- 4: Hole Ø 21 mm (0.83")

Electrical Characteristics

Nominal voltage	380-400V/3/50Hz - 460V/3/60Hz
Voltage range	340-440 V @ 50Hz - 414-506 V @ 60Hz
Winding resistance (between phases) +/- 7% at 25°C	5.03 Ω
Maximum Continuous Current (MCC)	10.1 A
Locked Rotor Amps (LRA)	32 A
Motor protection	Internal overload protector

Recommended Installation torques

Oil sight glass	50 Nm
Power connections / Earth connection	2 Nm / 2 Nm
Mounting bolts	15 Nm

Parts shipped with compressor

Mounting kit with grommets, bolts, nuts, sleeves and washers
Suction & Discharge solder sleeves, rotolock nuts and gaskets (shipped with rotolock version only)
Initial oil charge
Installation instructions

Approvals : CE certified, UL certified (file SA6873), CCC certified

*Singlepack: Compressor in cardboard box

**Industrial pack: 6 Unboxed compressors on pallet (order per multiples of 6)

Datasheet, performance data

Maneurop reciprocating compressor. NTZ096-4

Performance data at 50 Hz, EN 12900 rating conditions, Suction temp. = 20 °C

R404A

Cond. temp. in °C (tc)	Evaporating temperature in °C (to)							
	-45	-40	-35	-30	-25	-20	-15	-10

Cooling capacity in W

30	-	1 852	2 597	3 540	4 706	6 123	7 814	9 806	-
35	-	-	2 308	3 192	4 287	5 620	7 216	9 101	-
40	-	-	2 002	2 819	3 837	5 080	6 574	8 346	-
45	-	-	-	2 431	3 364	4 512	5 899	7 551	-
50	-	-	-	-	2 878	3 923	5 196	6 723	-
55	-	-	-	-	-	3 323	4 476	5 871	-
60	-	-	-	-	-	2 720	3 746	5 002	-

Power input in W

30	-	1 478	1 789	2 092	2 384	2 660	2 916	3 146	-
35	-	-	1 773	2 120	2 469	2 815	3 152	3 477	-
40	-	-	1 734	2 119	2 517	2 925	3 337	3 750	-
45	-	-	-	2 089	2 531	2 994	3 475	3 968	-
50	-	-	-	-	2 511	3 024	3 566	4 133	-
55	-	-	-	-	-	3 016	3 613	4 248	-
60	-	-	-	-	-	2 974	3 619	4 314	-

Current consumption in A

30	-	2.96	3.33	3.75	4.20	4.66	5.10	5.48	-
35	-	-	3.32	3.78	4.28	4.81	5.33	5.82	-
40	-	-	3.29	3.78	4.33	4.93	5.53	6.13	-
45	-	-	-	3.76	4.36	5.01	5.70	6.40	-
50	-	-	-	-	4.35	5.07	5.84	6.64	-
55	-	-	-	-	-	5.09	5.94	6.84	-
60	-	-	-	-	-	5.08	6.01	7.00	-

Mass flow in kg/h

30	-	45	63	86	114	149	192	244	-
35	-	-	59	82	110	145	188	240	-
40	-	-	54	77	105	140	183	234	-
45	-	-	-	70	98	133	175	227	-
50	-	-	-	-	91	125	167	218	-
55	-	-	-	-	-	115	157	207	-
60	-	-	-	-	-	105	145	194	-

Coefficient of performance (C.O.P.)

30	-	1.25	1.45	1.69	1.97	2.30	2.68	3.12	-
35	-	-	1.30	1.51	1.74	2.00	2.29	2.62	-
40	-	-	1.15	1.33	1.52	1.74	1.97	2.23	-
45	-	-	-	1.16	1.33	1.51	1.70	1.90	-
50	-	-	-	-	1.15	1.30	1.46	1.63	-
55	-	-	-	-	-	1.10	1.24	1.38	-
60	-	-	-	-	-	0.91	1.04	1.16	-

Nominal performance at to = -35 °C, tc = 40 °C

Cooling capacity	2 002	W
Power input	1 734	W
Current consumption	3.29	A
Mass flow	54	kg/h
C.O.P.	1.15	



to: Evaporating temperature at dew point
tc: Condensing temperature at dew point
Rating conditions : Suction gas temp. = 20 °C , Subcooling = 0 K

Pressure switch settings

Maximum HP switch setting	27.7	bar(g)
Minimum LP switch setting	0.1	bar(g)
LP pump down setting	0.1	bar(g)

Sound power data

Sound power level	83.6	dB(A)
With acoustic hood	77.6	dB(A)

Tolerance according EN12900

Datasheet, performance data

Maneurop reciprocating compressor. NTZ096-4

Performance data at 50 Hz, EN 12900 rating conditions, Superheat = 10 K

R404A

Cond. temp. in °C (tc)	Evaporating temperature in °C (to)							
	-45	-40	-35	-30	-25	-20	-15	-10

Cooling capacity in W

30	1 122	1 647	2 343	3 237	4 363	5 750	7 430	9 437	-
35	919	1 402	2 042	2 869	3 914	5 210	6 789	8 684	-
40	-	1 152	1 731	2 483	3 442	4 639	6 108	7 884	-
45	-	906	1 417	2 090	2 955	4 047	5 399	7 047	-
50	-	673	1 111	1 697	2 463	3 442	4 669	6 183	-
55	-	-	821	1 315	1 975	2 834	3 929	5 298	-
60	-	-	-	953	1 500	2 231	3 185	4 402	-

Power input in W

30	1 165	1 478	1 789	2 092	2 384	2 660	2 916	3 146	-
35	1 099	1 431	1 773	2 120	2 469	2 815	3 152	3 477	-
40	-	1 367	1 734	2 119	2 517	2 925	3 337	3 750	-
45	-	1 289	1 673	2 089	2 531	2 994	3 475	3 968	-
50	-	1 198	1 594	2 033	2 511	3 024	3 566	4 133	-
55	-	-	1 498	1 954	2 462	3 016	3 613	4 248	-
60	-	-	-	1 854	2 384	2 974	3 619	4 314	-

Current consumption in A

30	2.67	2.96	3.33	3.75	4.20	4.66	5.10	5.48	-
35	2.66	2.94	3.32	3.78	4.28	4.81	5.33	5.82	-
40	-	2.90	3.29	3.78	4.33	4.93	5.53	6.13	-
45	-	2.83	3.24	3.76	4.36	5.01	5.70	6.40	-
50	-	2.74	3.16	3.70	4.35	5.07	5.84	6.64	-
55	-	-	3.05	3.62	4.31	5.09	5.94	6.84	-
60	-	-	-	3.51	4.24	5.08	6.01	7.00	-

Mass flow in kg/h

30	38	55	76	102	134	172	217	269	-
35	34	51	71	97	129	167	212	265	-
40	-	45	66	91	123	160	206	259	-
45	-	39	59	84	115	153	198	250	-
50	-	33	52	76	106	143	188	240	-
55	-	-	43	67	96	132	176	228	-
60	-	-	-	57	85	120	163	215	-

Coefficient of performance (C.O.P.)

30	0.96	1.11	1.31	1.55	1.83	2.16	2.55	3.00	-
35	0.84	0.98	1.15	1.35	1.59	1.85	2.15	2.50	-
40	-	0.84	1.00	1.17	1.37	1.59	1.83	2.10	-
45	-	0.70	0.85	1.00	1.17	1.35	1.55	1.78	-
50	-	0.56	0.70	0.83	0.98	1.14	1.31	1.50	-
55	-	-	0.55	0.67	0.80	0.94	1.09	1.25	-
60	-	-	-	0.51	0.63	0.75	0.88	1.02	-

Nominal performance at to = -35 °C, tc = 40 °C

Cooling capacity	1 731	W
Power input	1 734	W
Current consumption	3.29	A
Mass flow	66	kg/h
C.O.P.	1.00	

to: Evaporating temperature at dew point

tc: Condensing temperature at dew point

Rating conditions : Superheat = 10 K , Subcooling = 0 K

Pressure switch settings

Maximum HP switch setting	27.7	bar(g)
Minimum LP switch setting	0.1	bar(g)
LP pump down setting	0.1	bar(g)

Sound power data

Sound power level	83.6	dB(A)
With acoustic hood	77.6	dB(A)

Tolerance according EN12900

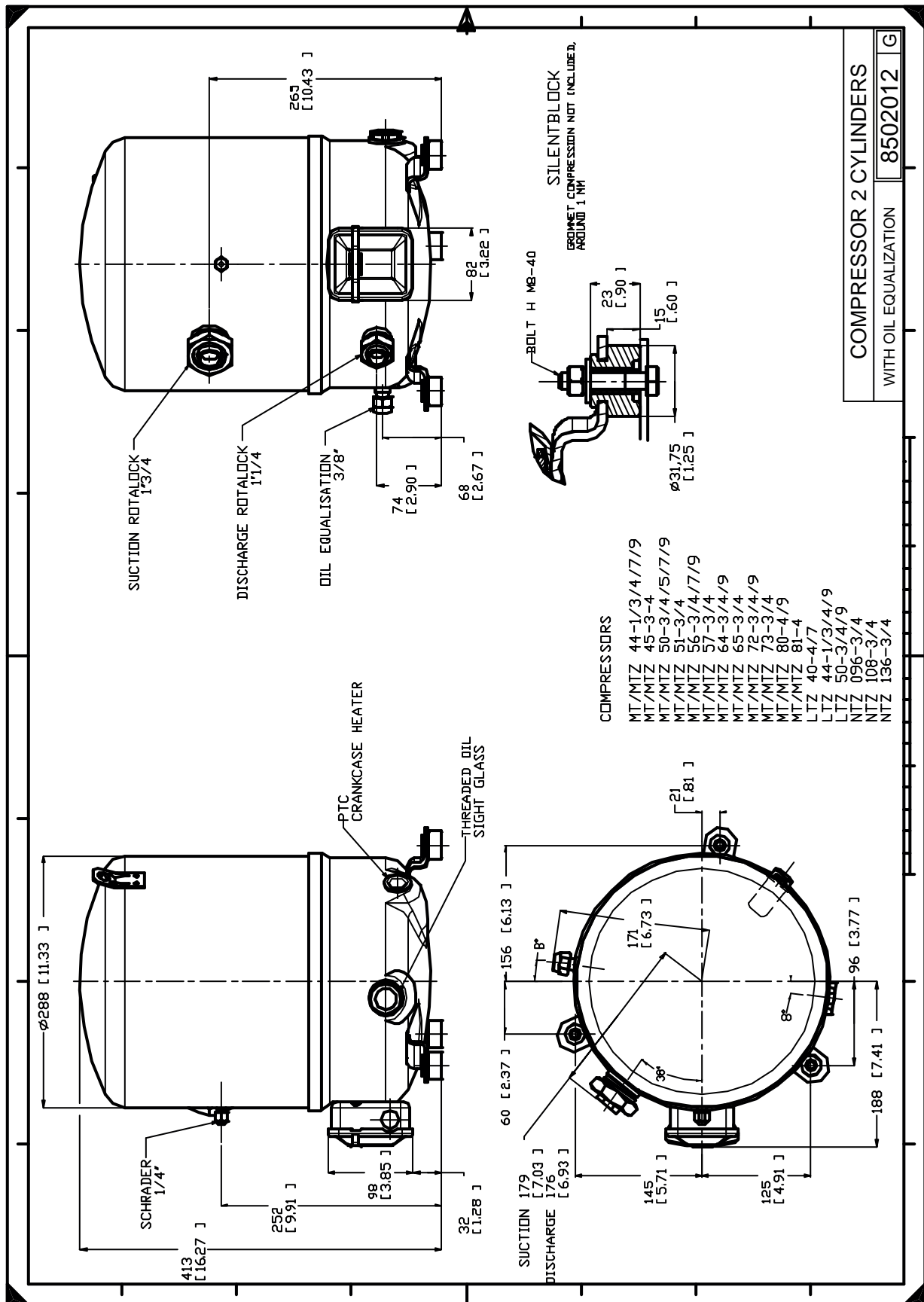

General Characteristics

Model number (on compressor nameplate)		NTZ096A4LR1B
Code number for Singlepack*		120F0234
Code number for Industrial pack**		120F0235
Drawing number		8502012g
Suction and discharge connections		Rotolock
Suction connection		1-3/4" Rotolock
Discharge connection		1-1/4" Rotolock
Suction connection with supplied sleeve		7/8" ODF
Discharge connection with supplied sleeve		3/4" ODF
Oil sight glass		Threaded
Oil equalisation connection		3/8" flare SAE
Oil drain connection		None
LP gauge port		Schrader
IPR valve		30 bar / 8 bar
Cylinders	2	
Swept volume	96 cm ³ /rev	
Displacement @ Nominal speed	16.7 m ³ /h @ 2900 rpm - 20.2 m ³ /h @ 3500 rpm	
Net weight	35 kg	
Oil charge	1.8 litre, POE - 175PZ	
Maximum system test pressure Low Side / High side	25 bar(g) / 30 bar(g)	
Maximum differential test pressure	30 bar	
Maximum number of starts per hour	12	
Refrigerant charge limit	5 kg	
Approved refrigerants	R404A, R452A	

Dimensions

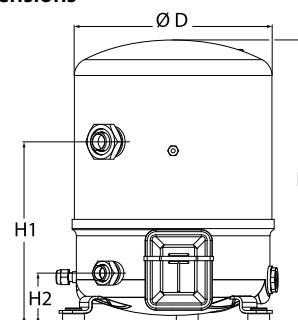

D=288 mm
H=413 mm
H1=265 mm
H2=74 mm
H3=- mm

Terminal box

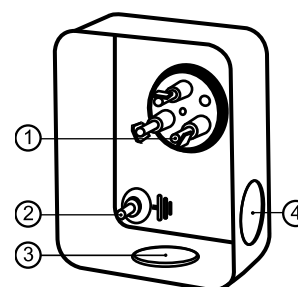

IP55 (with cable gland)

- 1: Spade connectors 1/4"
- 2: Earth M4-12
- 3: Knock-out Ø 21 mm (0.83")
- 4: Hole Ø 21 mm (0.83")

Electrical Characteristics

Nominal voltage	380-400V/3/50Hz - 460V/3/60Hz
Voltage range	340-440 V @ 50Hz - 414-506 V @ 60Hz
Winding resistance (between phases) +/- 7% at 25°C	5.03 Ω
Maximum Continuous Current (MCC)	10.1 A
Locked Rotor Amps (LRA)	32 A
Motor protection	Internal overload protector

Recommended Installation torques

Oil sight glass	50 Nm
Power connections / Earth connection	2 Nm / 2 Nm
Mounting bolts	15 Nm

Parts shipped with compressor

Mounting kit with grommets, bolts, nuts, sleeves and washers
Suction & Discharge solder sleeves, rotolock nuts and gaskets (shipped with rotolock version only)
Initial oil charge
Installation instructions

Approvals : CE certified, -, -

*Singlepack: Compressor in cardboard box

**Industrial pack: 6 Unboxed compressors on pallet (order per multiples of 6)

Datasheet, performance data

Maneurop reciprocating compressor. NTZ096-4

Performance data at 50 Hz, EN 12900 rating conditions, Suction temp. = 20 °C

R404A

Cond. temp. in °C (tc)	Evaporating temperature in °C (to)							
	-45	-40	-35	-30	-25	-20	-15	-10

Cooling capacity in W

30	-	1 852	2 597	3 540	4 706	6 123	7 814	9 806	-
35	-	-	2 308	3 192	4 287	5 620	7 216	9 101	-
40	-	-	2 002	2 819	3 837	5 080	6 574	8 346	-
45	-	-	-	2 431	3 364	4 512	5 899	7 551	-
50	-	-	-	-	2 878	3 923	5 196	6 723	-
55	-	-	-	-	-	3 323	4 476	5 871	-
60	-	-	-	-	-	2 720	3 746	5 002	-

Power input in W

30	-	1 478	1 789	2 092	2 384	2 660	2 916	3 146	-
35	-	-	1 773	2 120	2 469	2 815	3 152	3 477	-
40	-	-	1 734	2 119	2 517	2 925	3 337	3 750	-
45	-	-	-	2 089	2 531	2 994	3 475	3 968	-
50	-	-	-	-	2 511	3 024	3 566	4 133	-
55	-	-	-	-	-	3 016	3 613	4 248	-
60	-	-	-	-	-	2 974	3 619	4 314	-

Current consumption in A

30	-	2.96	3.33	3.75	4.20	4.66	5.10	5.48	-
35	-	-	3.32	3.78	4.28	4.81	5.33	5.82	-
40	-	-	3.29	3.78	4.33	4.93	5.53	6.13	-
45	-	-	-	3.76	4.36	5.01	5.70	6.40	-
50	-	-	-	-	4.35	5.07	5.84	6.64	-
55	-	-	-	-	-	5.09	5.94	6.84	-
60	-	-	-	-	-	5.08	6.01	7.00	-

Mass flow in kg/h

30	-	45	63	86	114	149	192	244	-
35	-	-	59	82	110	145	188	240	-
40	-	-	54	77	105	140	183	234	-
45	-	-	-	70	98	133	175	227	-
50	-	-	-	-	91	125	167	218	-
55	-	-	-	-	-	115	157	207	-
60	-	-	-	-	-	105	145	194	-

Coefficient of performance (C.O.P.)

30	-	1.25	1.45	1.69	1.97	2.30	2.68	3.12	-
35	-	-	1.30	1.51	1.74	2.00	2.29	2.62	-
40	-	-	1.15	1.33	1.52	1.74	1.97	2.23	-
45	-	-	-	1.16	1.33	1.51	1.70	1.90	-
50	-	-	-	-	1.15	1.30	1.46	1.63	-
55	-	-	-	-	-	1.10	1.24	1.38	-
60	-	-	-	-	-	0.91	1.04	1.16	-

Nominal performance at to = -35 °C, tc = 40 °C

Cooling capacity	2 002	W
Power input	1 734	W
Current consumption	3.29	A
Mass flow	54	kg/h
C.O.P.	1.15	



to: Evaporating temperature at dew point
tc: Condensing temperature at dew point
Rating conditions : Suction gas temp. = 20 °C , Subcooling = 0 K

Pressure switch settings

Maximum HP switch setting	27.7	bar(g)
Minimum LP switch setting	0.1	bar(g)
LP pump down setting	0.1	bar(g)

Sound power data

Sound power level	83.6	dB(A)
With acoustic hood	77.6	dB(A)

Tolerance according EN12900

Datasheet, performance data

Maneurop reciprocating compressor. NTZ096-4

Performance data at 50 Hz, EN 12900 rating conditions, Superheat = 10 K

R404A

Cond. temp. in °C (tc)	Evaporating temperature in °C (to)							
	-45	-40	-35	-30	-25	-20	-15	-10

Cooling capacity in W

30	1 122	1 647	2 343	3 237	4 363	5 750	7 430	9 437	-
35	919	1 402	2 042	2 869	3 914	5 210	6 789	8 684	-
40	-	1 152	1 731	2 483	3 442	4 639	6 108	7 884	-
45	-	906	1 417	2 090	2 955	4 047	5 399	7 047	-
50	-	673	1 111	1 697	2 463	3 442	4 669	6 183	-
55	-	-	821	1 315	1 975	2 834	3 929	5 298	-
60	-	-	-	953	1 500	2 231	3 185	4 402	-

Power input in W

30	1 165	1 478	1 789	2 092	2 384	2 660	2 916	3 146	-
35	1 099	1 431	1 773	2 120	2 469	2 815	3 152	3 477	-
40	-	1 367	1 734	2 119	2 517	2 925	3 337	3 750	-
45	-	1 289	1 673	2 089	2 531	2 994	3 475	3 968	-
50	-	1 198	1 594	2 033	2 511	3 024	3 566	4 133	-
55	-	-	1 498	1 954	2 462	3 016	3 613	4 248	-
60	-	-	-	1 854	2 384	2 974	3 619	4 314	-

Current consumption in A

30	2.67	2.96	3.33	3.75	4.20	4.66	5.10	5.48	-
35	2.66	2.94	3.32	3.78	4.28	4.81	5.33	5.82	-
40	-	2.90	3.29	3.78	4.33	4.93	5.53	6.13	-
45	-	2.83	3.24	3.76	4.36	5.01	5.70	6.40	-
50	-	2.74	3.16	3.70	4.35	5.07	5.84	6.64	-
55	-	-	3.05	3.62	4.31	5.09	5.94	6.84	-
60	-	-	-	3.51	4.24	5.08	6.01	7.00	-

Mass flow in kg/h

30	38	55	76	102	134	172	217	269	-
35	34	51	71	97	129	167	212	265	-
40	-	45	66	91	123	160	206	259	-
45	-	39	59	84	115	153	198	250	-
50	-	33	52	76	106	143	188	240	-
55	-	-	43	67	96	132	176	228	-
60	-	-	-	57	85	120	163	215	-

Coefficient of performance (C.O.P.)

30	0.96	1.11	1.31	1.55	1.83	2.16	2.55	3.00	-
35	0.84	0.98	1.15	1.35	1.59	1.85	2.15	2.50	-
40	-	0.84	1.00	1.17	1.37	1.59	1.83	2.10	-
45	-	0.70	0.85	1.00	1.17	1.35	1.55	1.78	-
50	-	0.56	0.70	0.83	0.98	1.14	1.31	1.50	-
55	-	-	0.55	0.67	0.80	0.94	1.09	1.25	-
60	-	-	-	0.51	0.63	0.75	0.88	1.02	-

Nominal performance at to = -35 °C, tc = 40 °C

Cooling capacity	1 731	W
Power input	1 734	W
Current consumption	3.29	A
Mass flow	66	kg/h
C.O.P.	1.00	

to: Evaporating temperature at dew point

tc: Condensing temperature at dew point

Rating conditions : Superheat = 10 K , Subcooling = 0 K

Pressure switch settings

Maximum HP switch setting	27.7	bar(g)
Minimum LP switch setting	0.1	bar(g)
LP pump down setting	0.1	bar(g)

Sound power data

Sound power level	83.6	dB(A)
With acoustic hood	77.6	dB(A)

Tolerance according EN12900

